

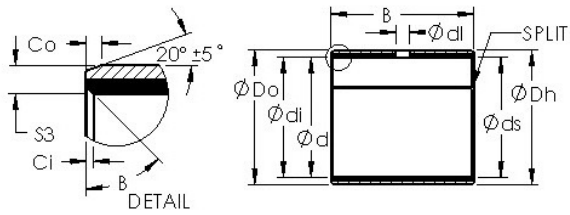

# BEARING de Mexico?S.A.



## AST AST50 09IB10 Simple bearings

Bearing No. AST50 09IB10

Bore Diameter	14,2875 mm
Bearing Type	straight
Shaft Dia., Nominal (d)	0.5625
Shaft Size (ds) - 0.5615	0.5605
Housing Bore Dia. (Dh) - 0.6566	0.6559
Bearing Bore after Mounting (di) - 0.5644	0.5617
Average Clearance (Cd)	0.0021
Wall Thickness (S3)	0.047
Bearing Length, Nominal (B)	0.625
Bearing Length Tolerance (B tol.) - +.010 / -0.010	+.010 / 0.010
OD Chamfer Length (Co)	0.023
ID Chamfer Angle (B deg.)	30
ID Chamfer Length (Ci)	0.014
Material	Carbon steel shell with PTFE / Fiber lining

AST50 09IB10 Bearing 2D drawings and 3D CAD models