

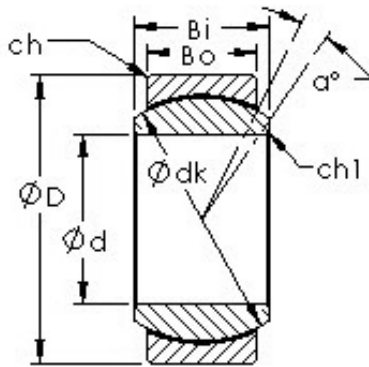

BEARING de Mexico?S.A.



AST GEG4C Simple bearings

Bearing No. GEG4C

Bore Diameter	4 mm
Outer Diameter	14 mm
Bearing Type - high misalignment	high misalignment
Bore Dia (d)	4.0000
Outer Dia (D)	14.0000
Outer Width (Bo)	4.0000
Inner Width (Bi)	7.0000
Dynamic Load Rating (Cr)	3,600
Static Load Rating (Cor)	9,100
Max. shaft corner radius, or 45 deg. chamfer (ch1)	0.300
Max. housing corner radius, or 45 deg. chamfer (ch)	0.300
Spherical Diameter (dk or Dk)	10.000
Mis-alignment Angle (α deg.)	20
Weight (g)	5.00
Material - Outer Ring - Carbon steel, Inner ring	52100 Chrome steel, or equivalent

GEG4C Bearing 2D drawings and 3D CAD models