

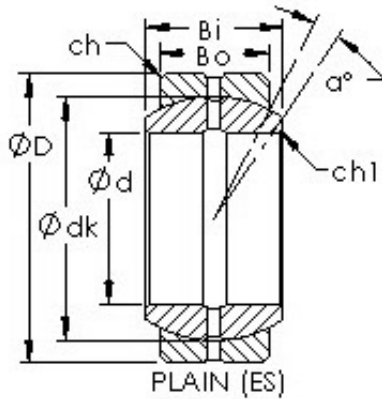

BEARING de Mexico?S.A.



AST GEZ38ES Simple bearings

Bearing No. GEZ38ES

Bore Diameter	38,1 mm
Outer Diameter	61,9125 mm
Bearing Type	plain
Bore Dia (d)	1.5000
Outer Dia (D)	2.4375
Outer Width (Bo)	1.1250
Inner Width (Bi)	1.3120
Dynamic Load Rating (Cr)	28,099
Static Load Rating (Cor)	84,298
Max. shaft corner radius, or 45 deg. chamfer (ch1)	0.024
Max. housing corner radius, or 45 deg. chamfer (ch)	0.040
Spherical Diameter (dk or Dk)	2.154
Mis-alignment Angle (a deg.)	6
Weight (g)	420.00
Material	52100 Chrome steel, or equivalent

GEZ38ES Bearing 2D drawings and 3D CAD models