

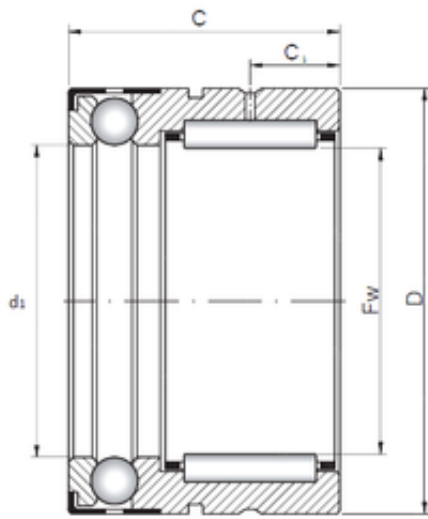

BEARING de Mexico?S.A.



ISO NX 35 Z Complex bearings

Bearing No. NX 35 Z

Size	35x47x30 mm
Bore Diameter	35 mm
Outer Diameter	47 mm
Width	30 mm
d1	35 mm
Fw	35 mm
D	47 mm
C	30 mm
C1	10 mm

NX 35 Z Bearing 2D drawings and 3D CAD models